

## ASSEMBLY INSTRUCTIONS

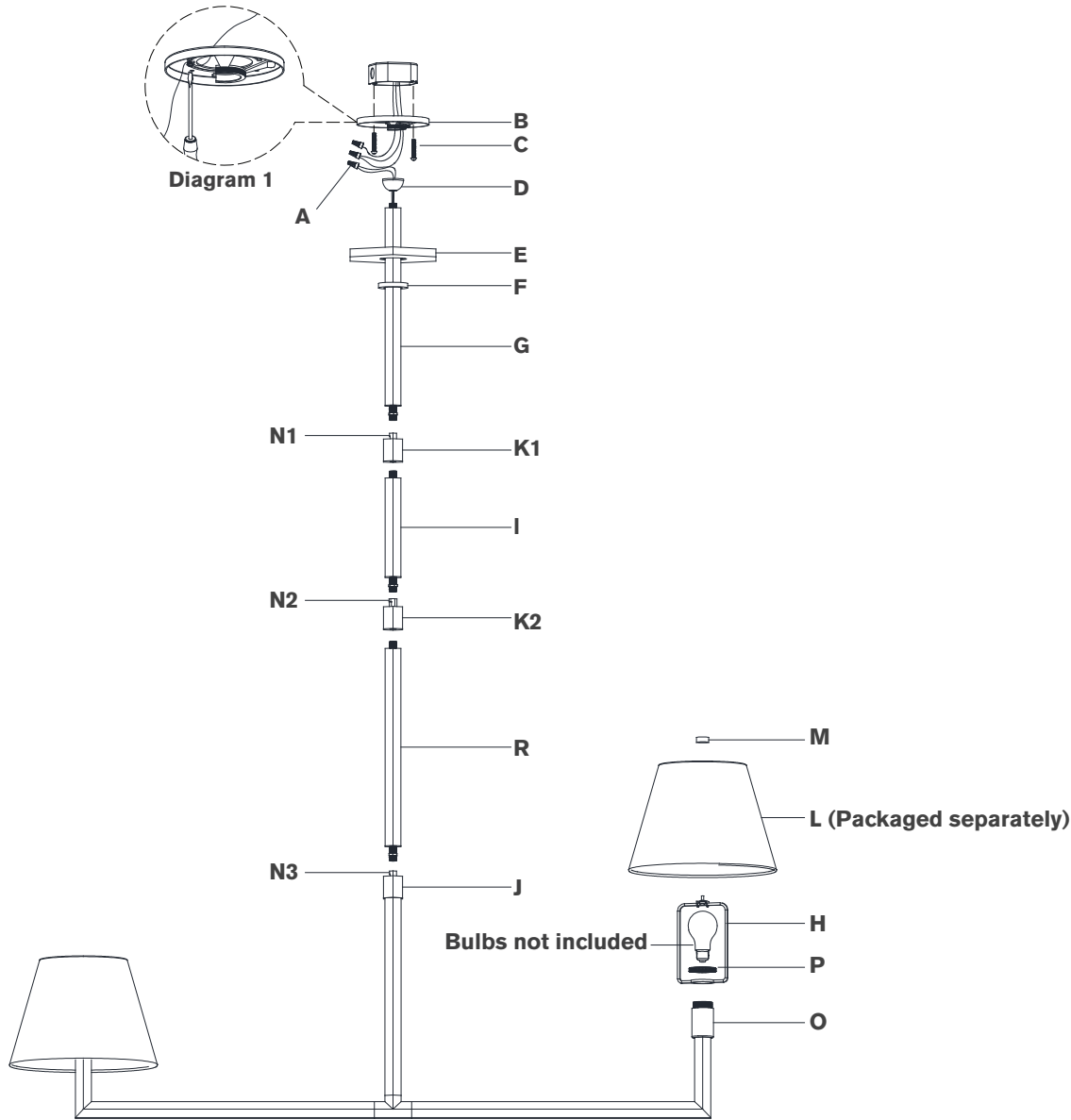

## Olivier 65" Linear Chandelier

Item # PCD5002

### NOTICE:

This light fixture should be installed in accordance with all applicable, local installation codes, and by a person familiar with the construction and operation of it, as well as the hazards involved. Inspect item and contents carefully. If any damage or defect is found, do not install. Retain all packaging material until installation is complete and approved.

### TOOLS REQUIRED (NOT INCLUDED):

Phillips Screwdriver      Slotted Screwdriver      Wire Cutters  
Slip Joint Pliers      Wire Strippers

1. Carefully remove all parts from the box. Place on a clean, soft surface.
2. Remove mounting plate (B) from canopy (E) by removing collar ring (F).
3. Install mounting plate (B) to junction box and secure with mounting screws (C).
4. Feed fixture wires through rod (R), then connect to hickey (N3) and secure with coupling (K2) and hickey (N2). Repeat for rod (I), connecting to hickey (N2) and secure with coupling (K1) and hickey (N1).
5. Continue feeding fixture wires through rod (G), collar ring (F) and canopy (E).
6. Holding fixture upright, slide collar ring (F), canopy (E) down rods and rest on top of fixture (J). Then connect rod (G) to hickey (N1), securing with swivel ball (D).

**NOTE:** Slide components down slowly to avoid damages.

7. Hang fixture swivel ball (D) to center of mounting plate (B).
8. Cut excess wires, being sure to leave enough to reach the junction box. Separate wires, and strip insulation on each 5/8".
9. Wrap fixture ground wire (bare copper) around the green grounding screw (see diagram 1). Tighten. Continue fixture ground wire and connect to supply ground wire (usually green or bare copper) using wire nut (A).

**NOTE:** It is imperative that the fixture is grounded.

VISUAL COMFORT



## ASSEMBLY INSTRUCTIONS

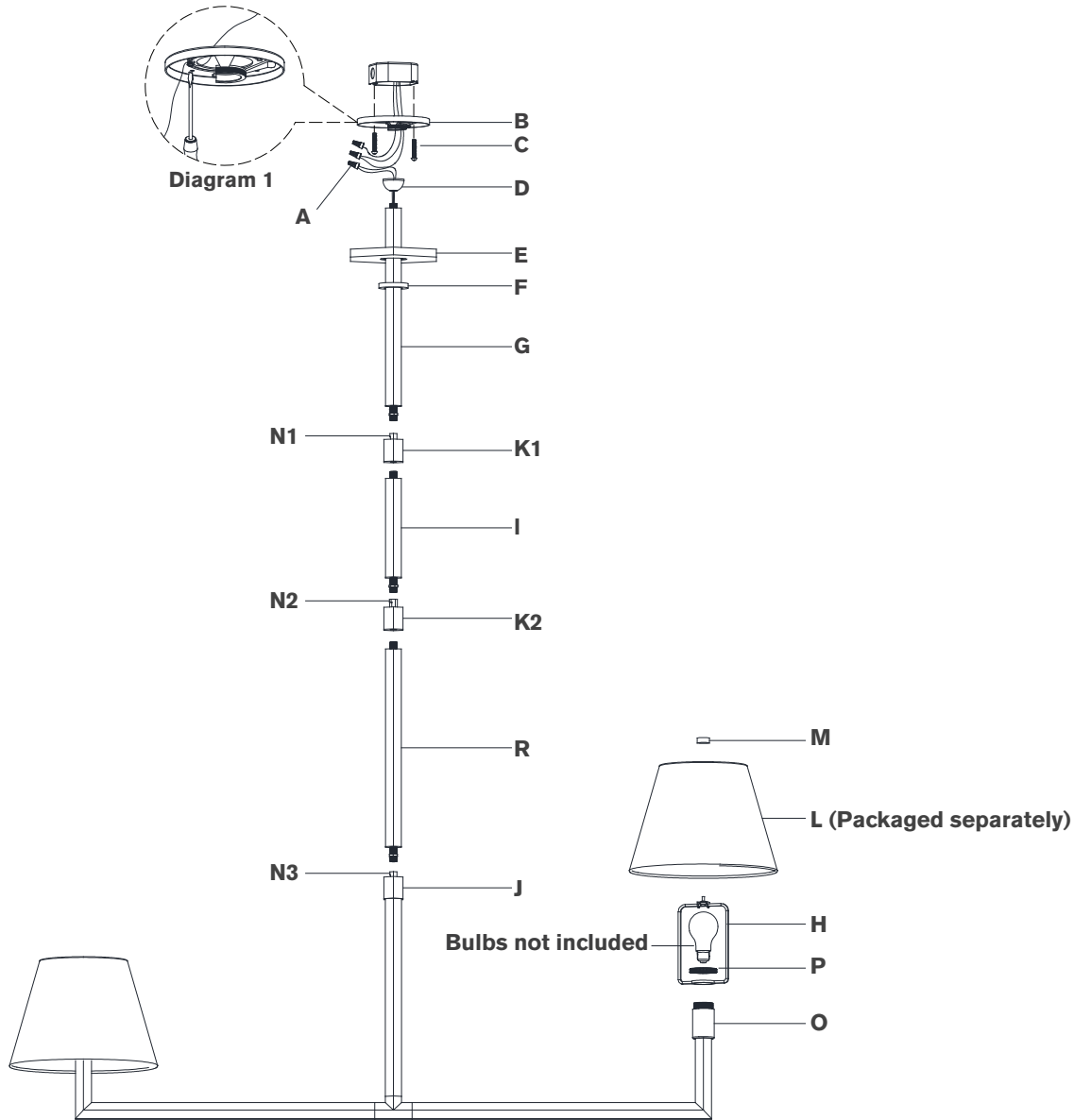

## Olivier 65" Linear Chandelier

Item # PCD5002

### NOTICE:

This light fixture should be installed in accordance with all applicable, local installation codes, and by a person familiar with the construction and operation of it, as well as the hazards involved. Inspect item and contents carefully. If any damage or defect is found, do not install. Retain all packaging material until installation is complete and approved.

10. Connect fixture neutral wire (white) to the supply neutral wire (usually white) using wire nut (A).

11. Connect fixture hot wire (black) to the supply hot wire (usually black) using wire nut (A).

**CAUTION:** Do not reverse the hot and neutral connections.

12. Make sure all wire connections are tight, then carefully tuck into the junction box.

13. Install canopy (E) to mounting plate (B) and secure with collar ring (F).

14. Remove socket rings (P) from sockets (O), then install harps (H) to sockets and secure with socket rings (P).

15. Install light bulbs into the sockets.

16. Remove finials (M) from harps (H).

17. Remove shades (L) from packaging, then install shades (L) to harps (H) using finials (M).

**NOTE:** If shade has additional packaging, carefully cut off from interior of shade to avoid damages.

**Care Instructions:** Clean only with a soft dry cloth or feather duster. Do not use abrasive or chemical agents.